

## FEATURES:

- ✓ Architectural sound absorbing Eco Felt Acoustic panel.
- ✓ Made from recyclable plastic material available in different thicknesses.
- ✓ Class1 Fire rated with 0.7 Noise Reduction Coefficient/1" Acoustic.
- ✓ Light source: COB LED.
- ✓ High efficiency integral reflector combined with opal lens insert provide excellent lighting distribution.
- ✓ Square internal louver is available in a wide range of finishes.
- ✓ Aluminum body of the luminaire comes with built-in-driver.
- ✓ LED Spot is rated for 60,000hrs. L70 with +85 CRI.
- ✓ Has a proven record in office, commercial and retail installations.
- ✓ Custom modifications are available.
- ✓ ED luminaires are certified to CSA and UL Standards. **reinventlight**

### HEIGHT

- 12 Inch
- 16 Inch
- 24 Inch

### VOLTAGE

- 120V
- 277V
- 347V\*

\*Not available for all configurations.

### MOUNTING

- S4-Suspension 4Feet
- S6-Suspension 6Feet
- S  Feet\*

\*Please specify required Length.

### ED CUBIC FINISH

- WH - White
- BK - Black
- GR - Grey

### SOURCE

- 15W LED
- 20W LED
- 25W LED

### DRIVER

- ST - Standard
- DT - ELV
- DL - 0-10V Dimming (1%)
- \*

\* Please specify dimming method (ELV).

### LOUVER

- WH - White
- BK - Black
- SL - Silver
- GL - Gold
- RG - Rose Gold

### CCT

- 30K - 3000Kelvin
- 35K - 3500Kelvin
- 40K - 4000Kelvin
- DW - Dim to Warm

\*Other options are available.

### ACOUSTIC FINISH\*

<input type="checkbox"/> 01	<input type="checkbox"/> 02	<input type="checkbox"/> 03	<input type="checkbox"/> 04	<input type="checkbox"/> 05	<input type="checkbox"/> 06	<input type="checkbox"/> 07	<input type="checkbox"/> 09	<input type="checkbox"/> 11	<input type="checkbox"/> 12
<input type="checkbox"/> 15	<input type="checkbox"/> 18	<input type="checkbox"/> 24	<input type="checkbox"/> 25	<input type="checkbox"/> 26	<input type="checkbox"/> 28	<input type="checkbox"/> 30	<input type="checkbox"/> 31	<input type="checkbox"/> 32	<input type="checkbox"/> 33

\* Please specify Acoustic Trim & Bottom Layer, for example (02/26)

### LUMEN OUTPUT:

Watts	30K	35K	40K
15W	1400 lm	1430 lm	1460 lm
20W	1910 lm	1950 lm	1990 lm
25W	2350 lm	2400 lm	2450 lm

Project:

Type:

### SPECIFICATION:

**Sonic CUBIC+**  HEIGHT -  SOURCE -  VOLTAGE -  DRIVER -  MOUNTING -  LENS -  CUBIC FINISH -  /  ACOUSTIC FINISH -  CCT

Enter the Product Code into the boxes above.

**SIZE:**

H - Height	Width	Length
12 Inch = 11.75 Inch	8.00 Inch	8.00 Inch
16 Inch = 15.75 Inch	8.00 Inch	8.00 Inch
24 Inch = 23.75 Inch	8.00 Inch	8.00 Inch

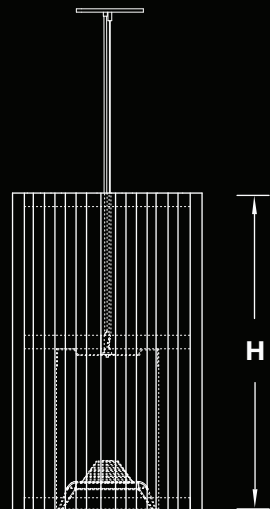
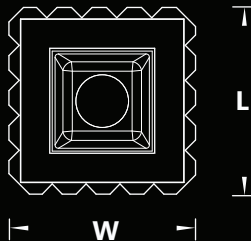

**FINISHES:**



(02/01)



(02/32)



(02/11)



(02/30)



(02/06)



(02/25)



(02/15)



(02/09)