



FEATURES:

- Architectural luminaire with direct lighting distribution.
- Light source: COB LED.
- Low glare opal lens is built in to the integral specular reflector for even light distribution.
- Steel body of the luminaire with integral driver comes in white finish.
- Suitable for surface mounted installations.
- LED Spot is rated for 60,000hrs. L70 and +85CRI.
- Has a proven record in office and commercial installations.
- Custom modification are available.
- ED luminaires are certified to CSA and UL standards.

SPECIFICATION: ED PRO+

SOURCE	VOLTAGE	DRIVER	MOUNTING	LENS	FINISH	CCT
10W LED	120V	ST - Standard	SF - Surface	OP - Opal	WH - White	30K - 3000Kelvin
20W LED	277V	DL - 0.10V Dimming		PR - Prismatic		35K - 3500Kelvin
30W LED	347V*	DM - Dimming**				40K - 4000Kelvin

* Not available for all configurations.
 ** Please specify dimming requirements.

DIMENSIONS:

Width: 7 1/2"
 Height: 5 15/16"

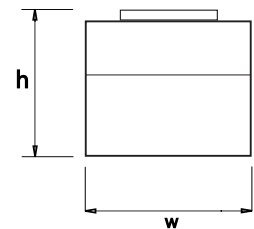

LUMEN OUTPUT:

Watts	30K	35K	40K
10W	975 lm	1000 lm	1025 lm
20W	1950 lm	2000 lm	2050 lm
30W	2925 lm	3000 lm	3075 lm

Project:

Type:

Edison Lighting Group Ltd.

1303 Ringwell Dr. Unit #2, Newmarket, ON L3Y 8T9
 Tel: 905-830-0339 or 1-800-667-9281 Fax: 905-898-6439 or 1-800-667-9302
 www.edisonlighting.ca info@edisonlighting.ca