



Installation Instructions

for Recessed Mounting Linear Extrusions

1.

Install as per Electrical Code by a certified Electrician.

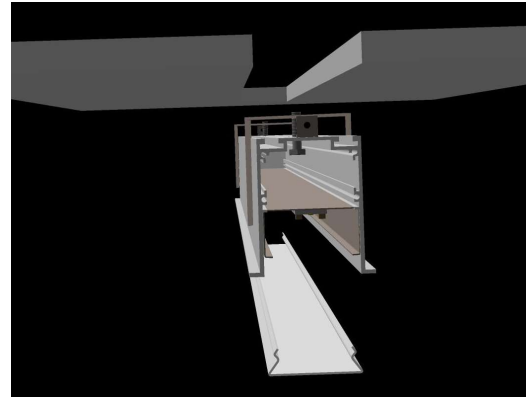
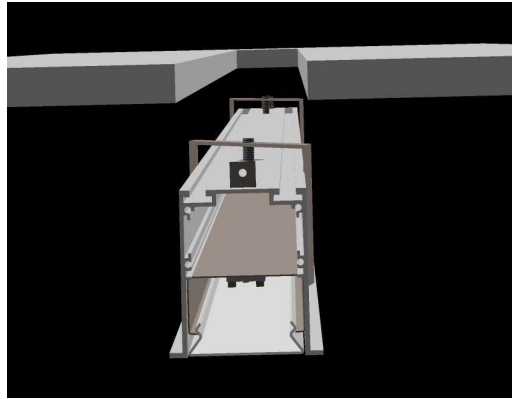

2.

Remove the Opal lens and LED plate from the fixture.

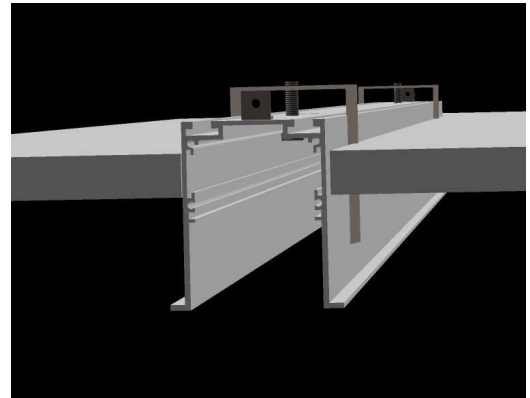
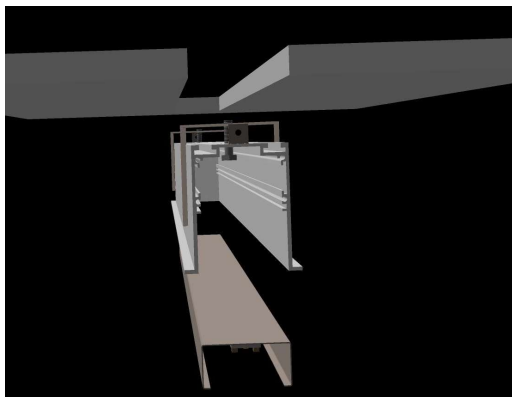

3.

Insert the fixture through the opening in the ceiling.

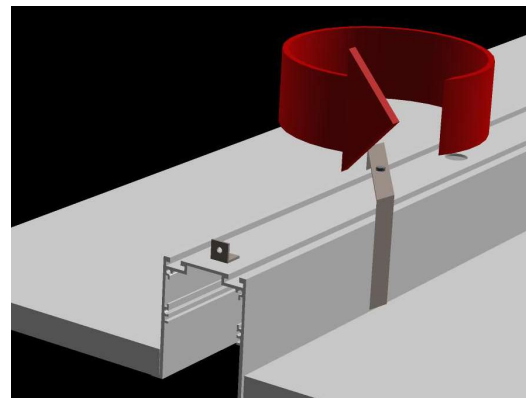
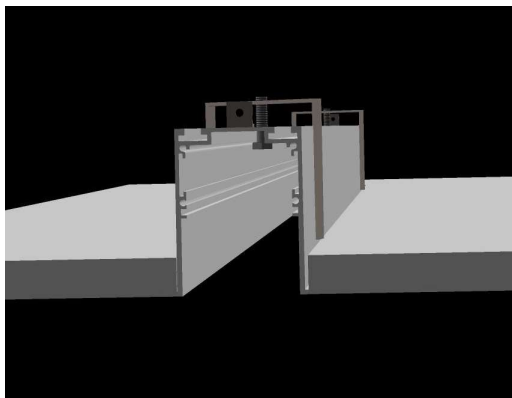

4.

Twist the bracket so that the U channel is now supporting the fixture.

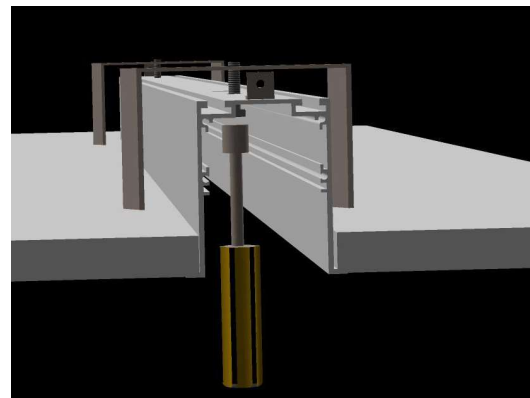
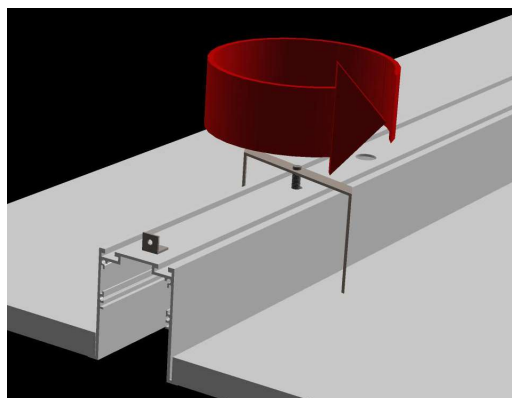

5.

Adjust the height by turning the bolt on the underside of the fixture. It should be flush with the ceiling'